

Run Remote Desktop with Private Matter Gateway (PMG)

RDP Access Matrix

RDP Client/Host	Windows 11 Pro Host	Windows 10 Pro Host
iOS Device Client	Microsoft Windows App Mobile app	Microsoft Windows App Mobile app
Android Device Client	Microsoft RD Client app	Microsoft RD Client app
Windows Device Client	Microsoft Remote Desktop app	Microsoft Remote Desktop app
macOS Device Client	Microsoft Remote Desktop for Mac app	Microsoft Remote Desktop for Mac app

There are 8 sections to this document.

1. iOS Device Client accessing Windows 11 Pro Host
2. Android Device Client accessing Windows 11 Pro Host
3. Windows Device Client accessing Windows 11 Pro Host
4. macOS Device Client accessing Windows 11 Pro Host
5. iOS Device Client accessing Windows 10 Pro Host
6. Android Device Client accessing Windows 10 Pro Host
7. Windows Device Client accessing Windows 10 Pro Host
8. macOS Device Client accessing Windows 10 Pro Host

Please consult the section that pertains to the client that you use to do Remote Desktop.

If you already have Remote Desktop enabled in the target host, you should still record the IP address of the target host as it is required to access the target when you use PMG to do Remote Desktop.

Section 1. iOS Device Client accessing Windows 11 Pro Host

1.1 Enable Windows 11 Pro Host for Remote Desktop Access

Requirement: Windows 11 Pro is required for Remote Desktop service, please upgrade your windows 11 to "Pro" version if it is not.

Step 1. (1)Click on Windows icon --> (2) Select Settings

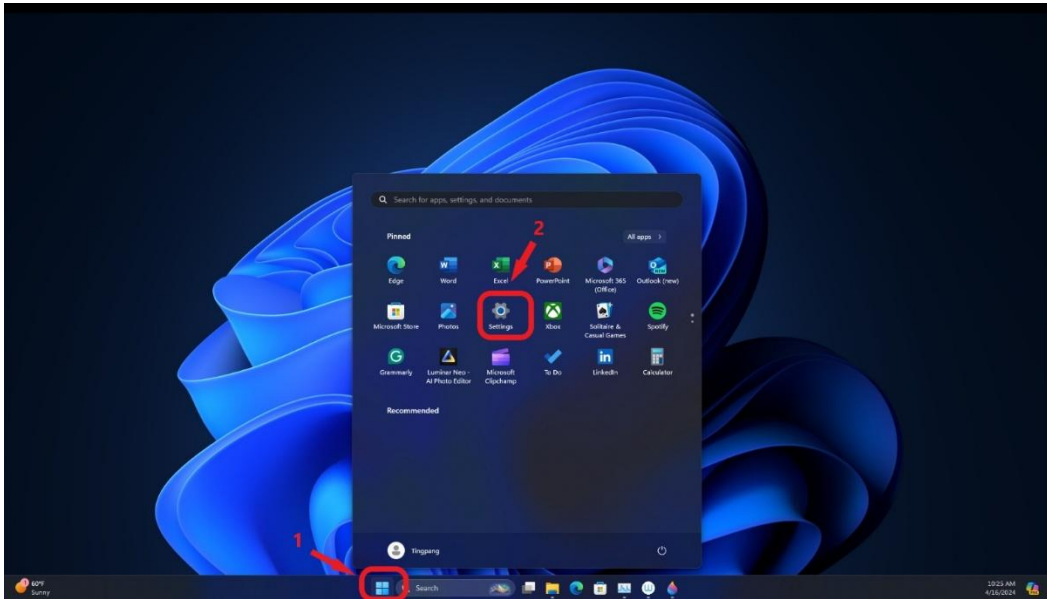

Step 2. (1) Select Network & Internet → (2) Ethernet (Pick the one that is enabled/active) → (3)Right Arrow to expand next window

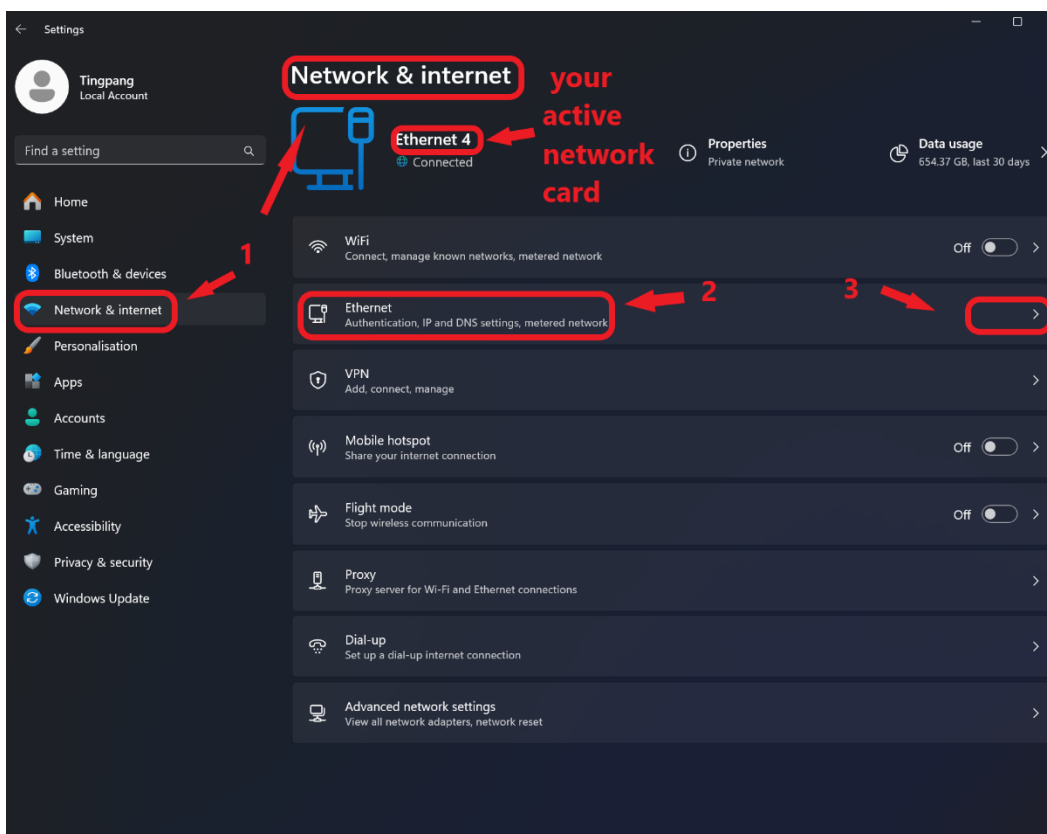

Step 3. Locate and Record Your Host's IP Address

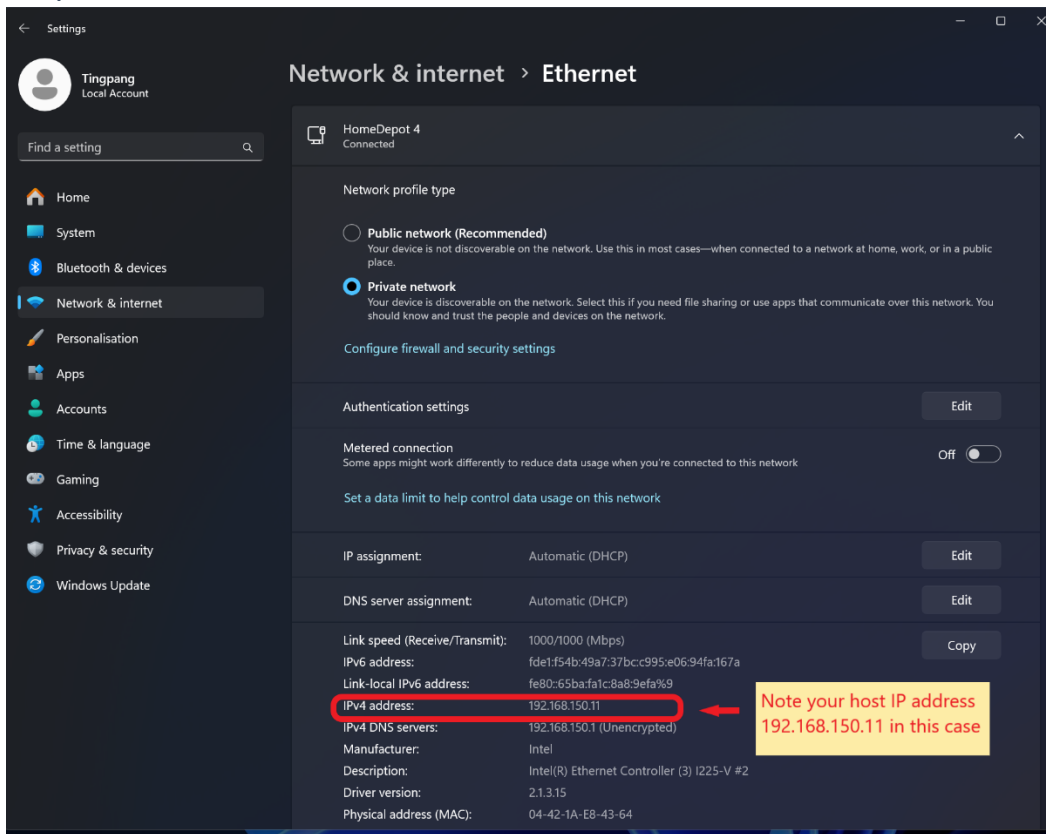

Please record the IP address.

Step 4. (1) System → (2) Remote Desktop → (3) click on the arrow to expand next window

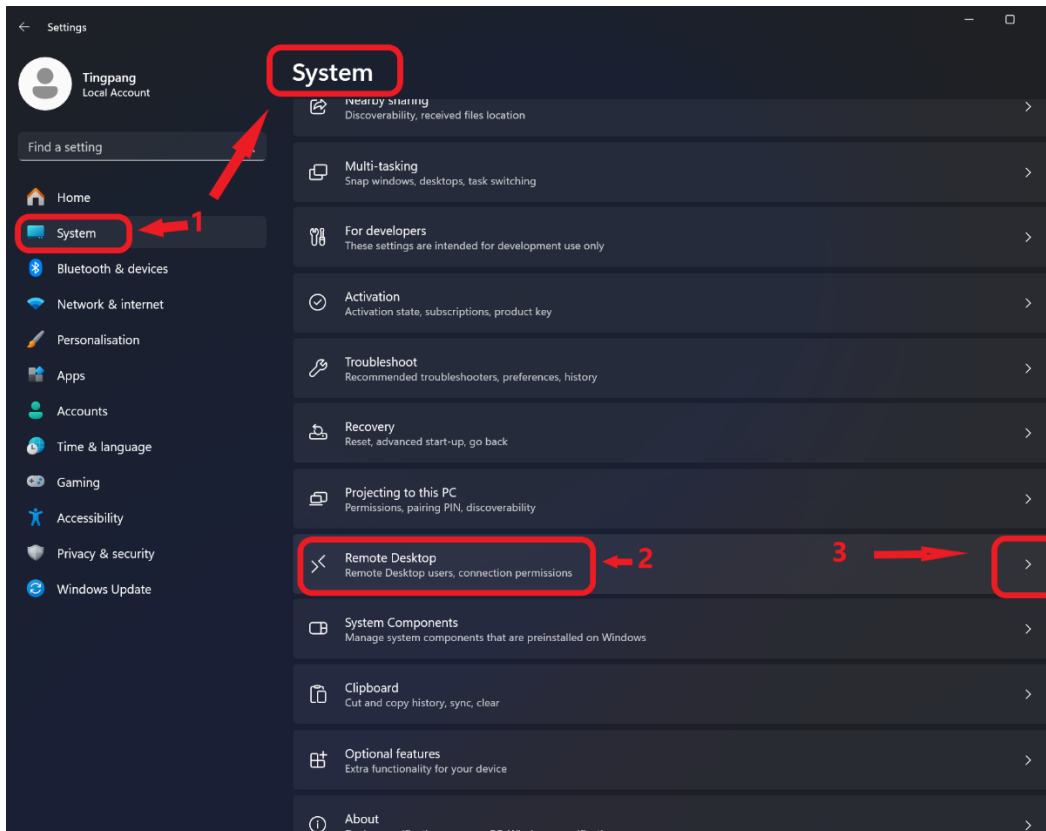

Step 5. (1) Switch on Remote Desktop → (2) Require Network Level Authentication to connect (recommended) → (3) Note the port number if you have changed it.

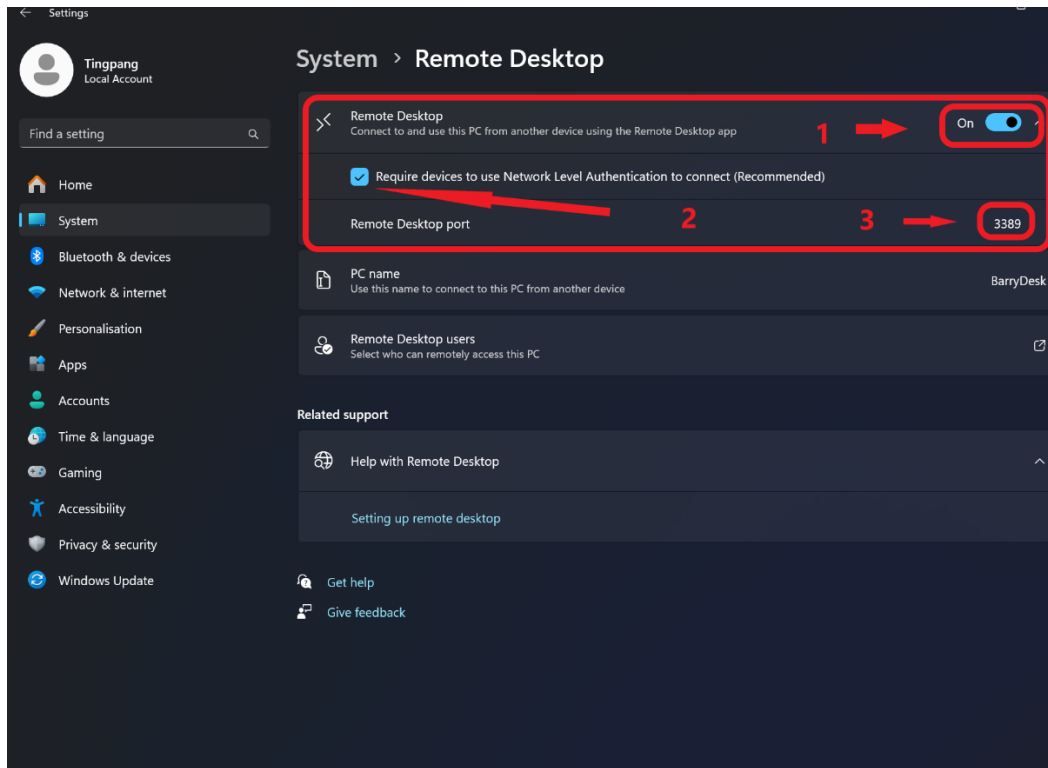

Step 6. Modify user setting to allow access → Remote Desktop Users, click on arrow → Add users setting if required (the current user can sign on Remote Desktop by default)

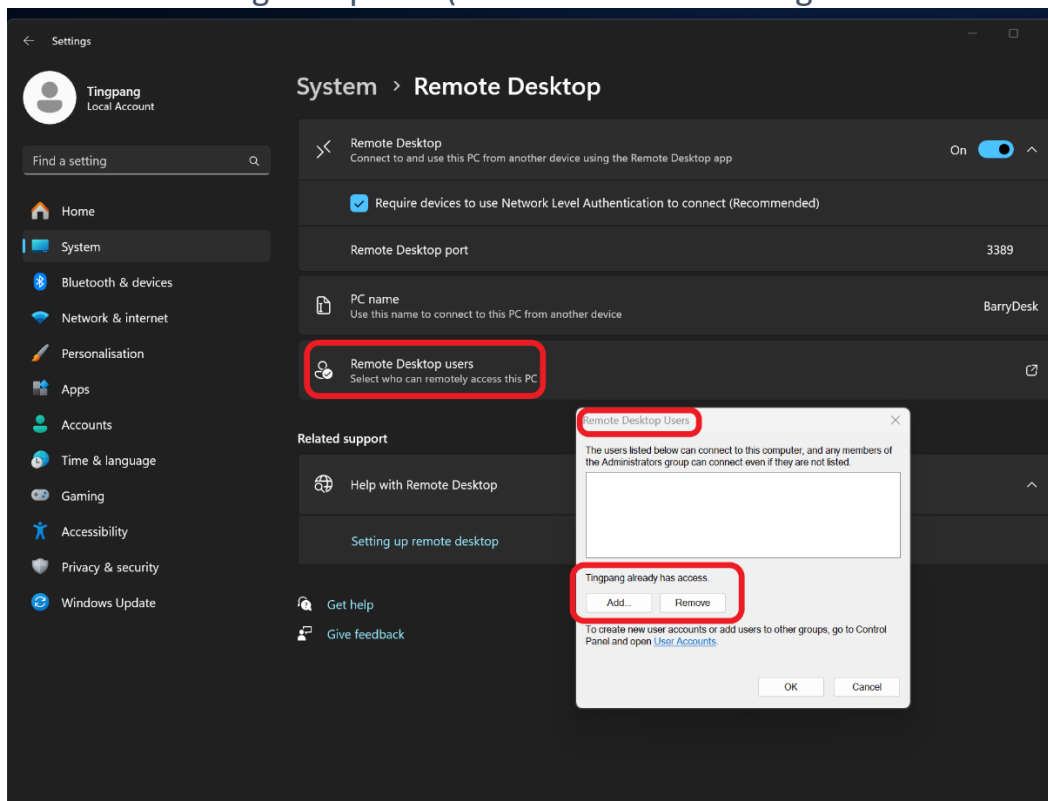

Your Windows 11 Pro Host is now setup to accept Remote Desktop request now.

1.2 Setup iOS Device Client:

Step 1 Click on App Store

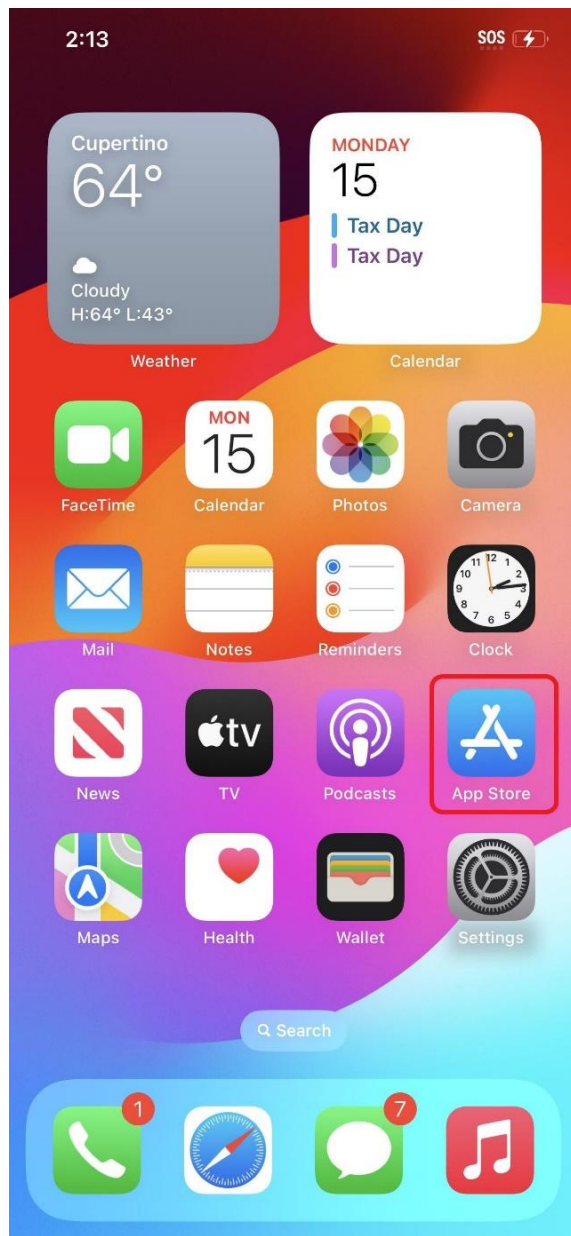

Step 2 Search Windows App Mobile, click the download icon

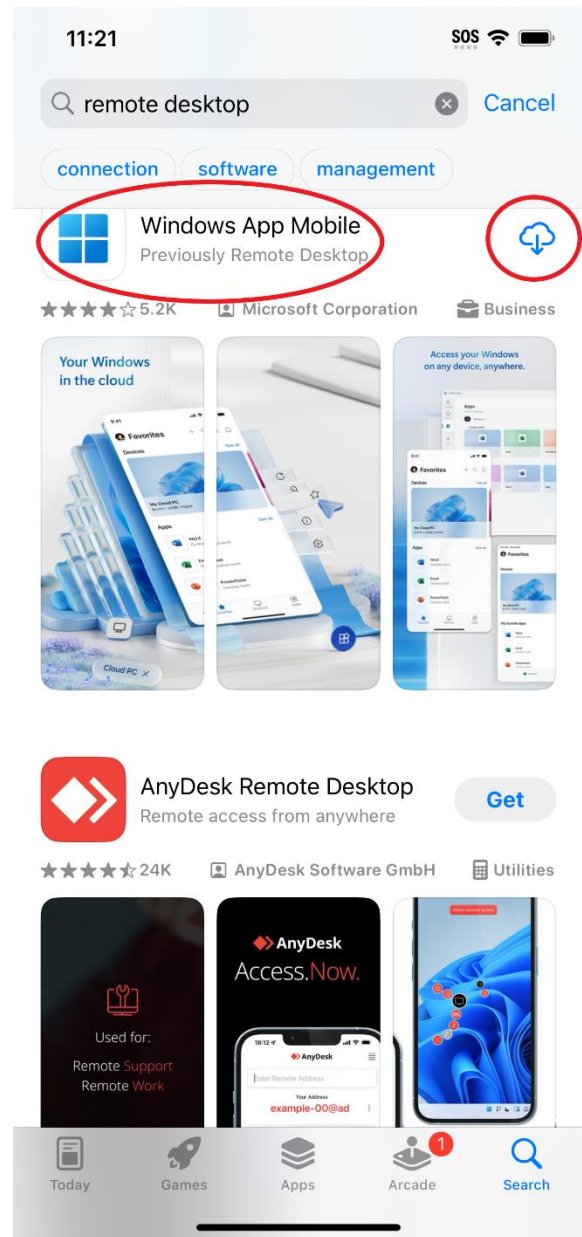

Step 3 Open Windows App Mobile

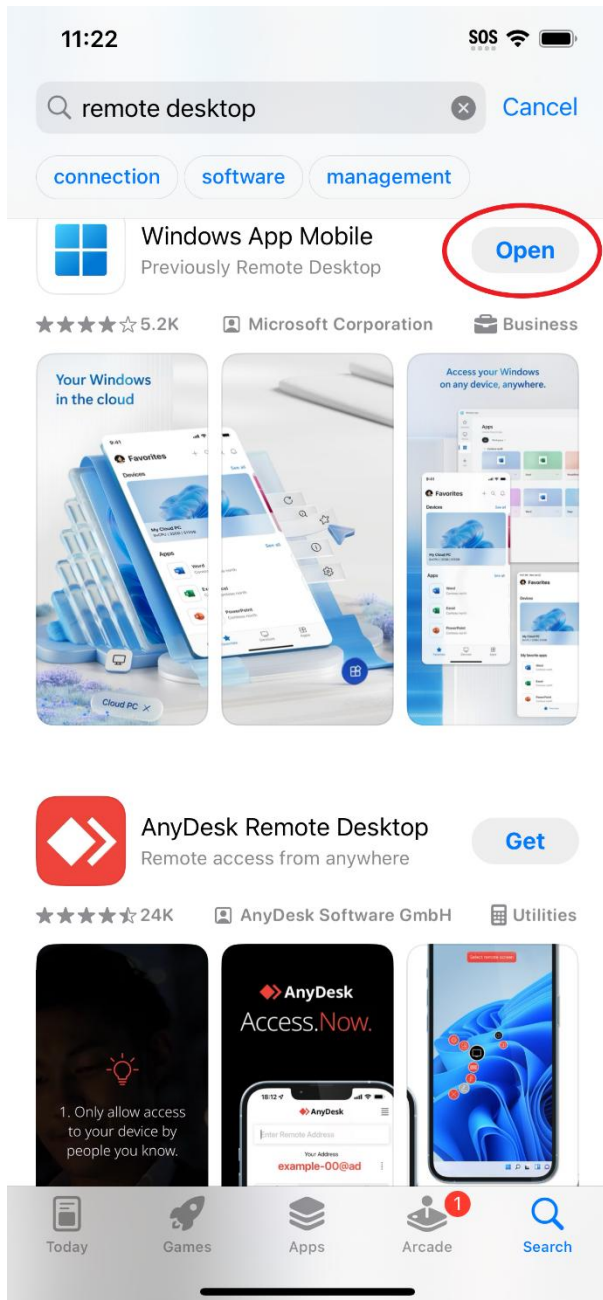

Step 4 Allow Windows App Mobile to search LAN

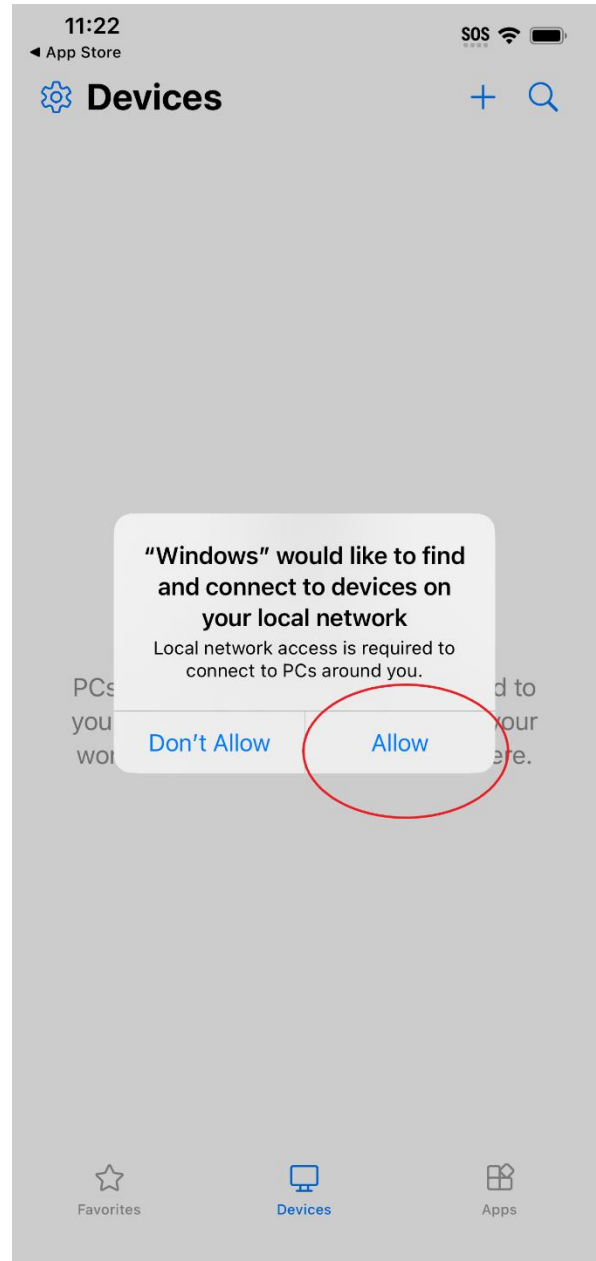

Step 5 Allow Bluetooth

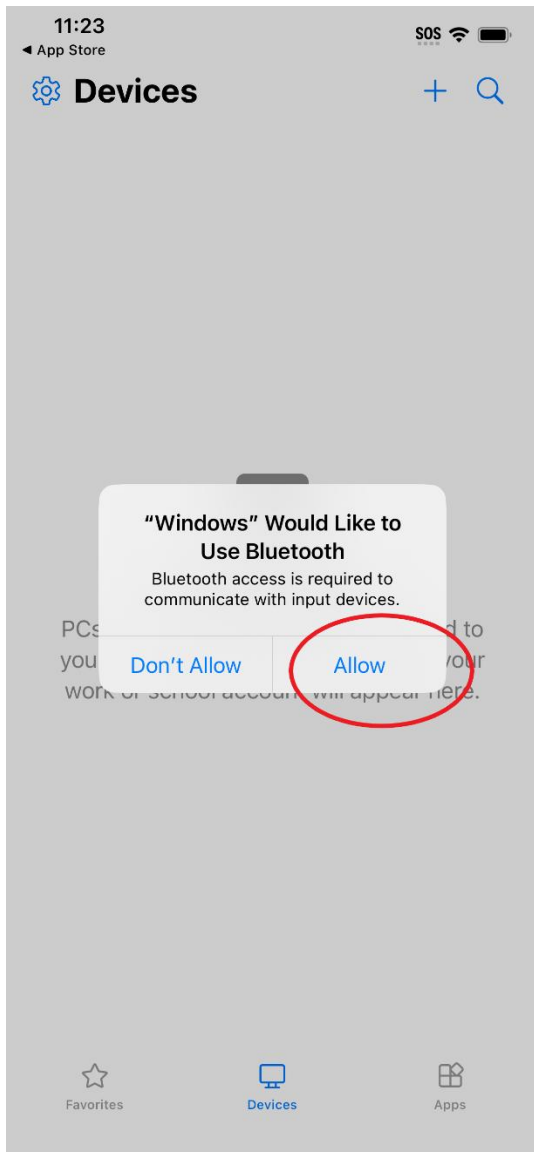

Step 6 Add PC

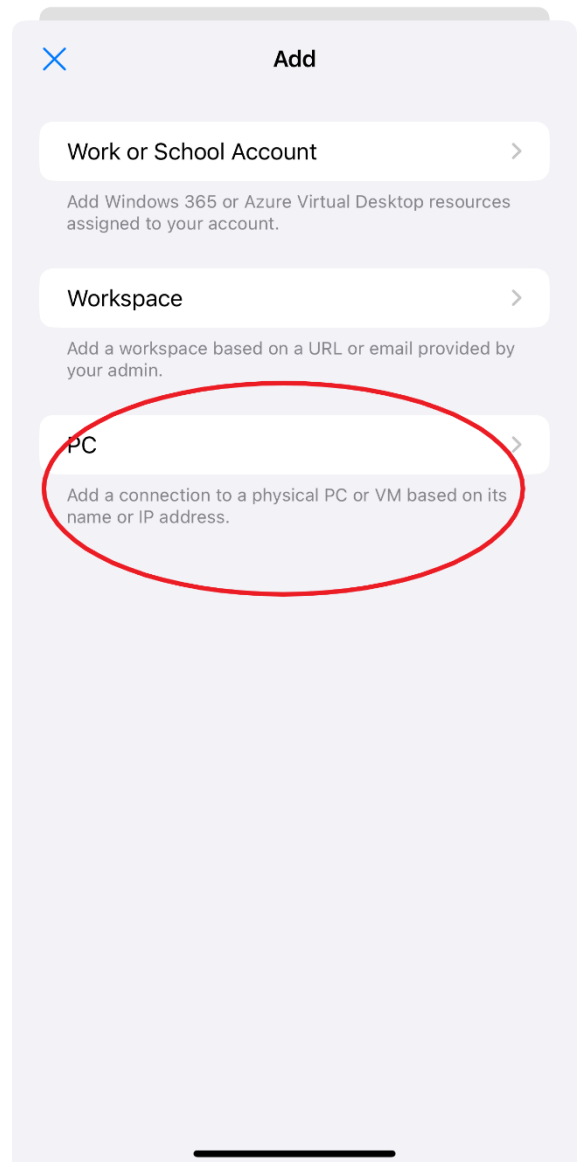

Step 7 Add PC by IP

Add PC Save

PC Name Hostname or IP Address >

Credentials Ask When Required >

GENERAL

Friendly Name Optional >

Admin Mode ☐

Swap Mouse Buttons ☐

GATEWAY

No Gateway Configured >

DEVICE & AUDIO REDIRECTION

Sound Play on This Device >

Microphone ☐

Camera ☐

Clipboard ☒

Storage ☐

YubiKey ☒

Your cameras, location and microphone cannot be used in a remote session. [Grant device access.](#)

Step 8 Enter Target Host IP Address, then click the back arrow

PC Name

Hostname or IP Address

192.168.150.11

Examples:

fdf4:17da:124c:2:ddad:6237:52f3:b778
officepc.contoso.com
studypc.local
192.168.7.175
studypc

[fdf4:17da:124c:2:ddad:6237:52f3:b778]:3390
officepc.contoso.com:3390

1 2 3 4 5 6 7 8 9 0

@ & % ? , = []

#+= _ : - +

ABC . / .com return

Step 9 Save the PC

Edit PC Save

PC Name **192.168.150.11** >

Credentials Ask When Required >

GENERAL

Friendly Name Optional >

Admin Mode ☐

Swap Mouse Buttons ☐

GATEWAY

No Gateway Configured >

DEVICE & AUDIO REDIRECTION

Sound Play on This Device >

Microphone ☐

Camera ☐

Clipboard ☒

Storage ☐

YubiKey ☒

Your cameras, location and microphone cannot be used in a remote session. [Grant device access.](#)

Step 10 Connect your device to PMG using OpenVPN Connect app

Step 11 Select saved PC to Make RDP connection

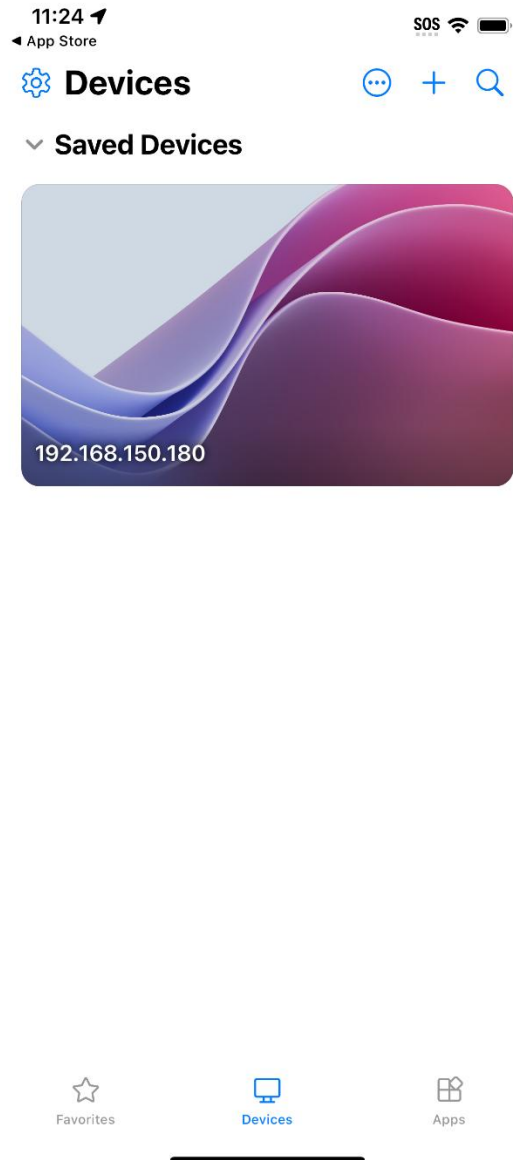

Step 12 Enter your user name and password to login

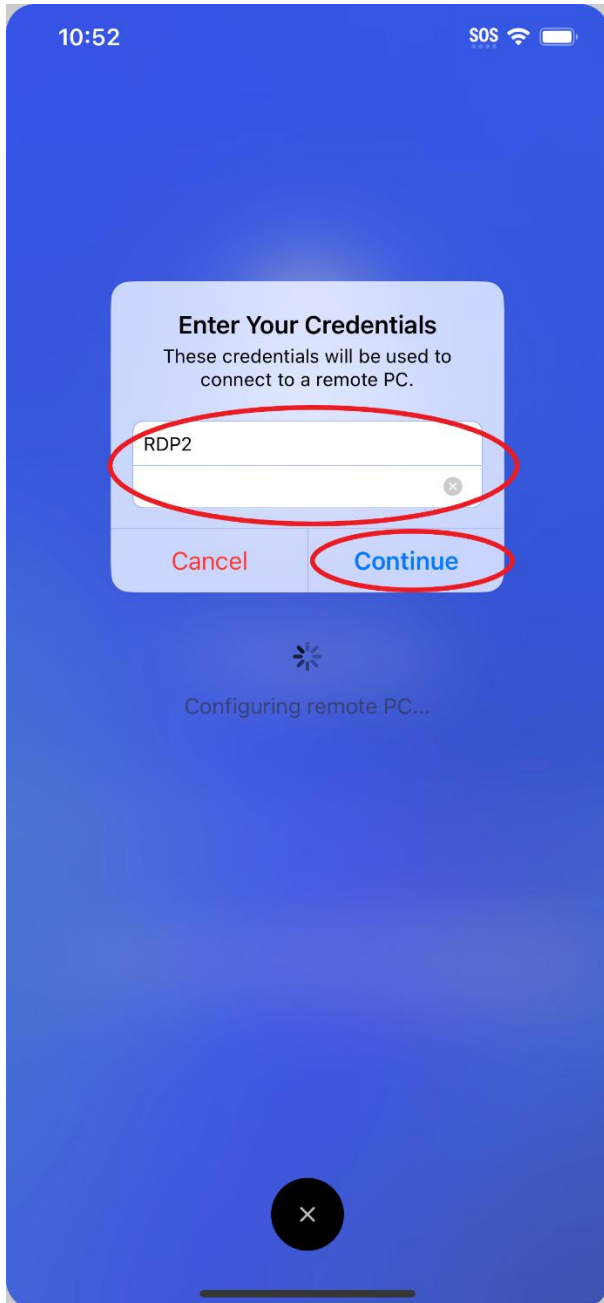

Step 13 You have successfully made the Remote Desktop Connection, please click "Yes" to Login and start the RDP session

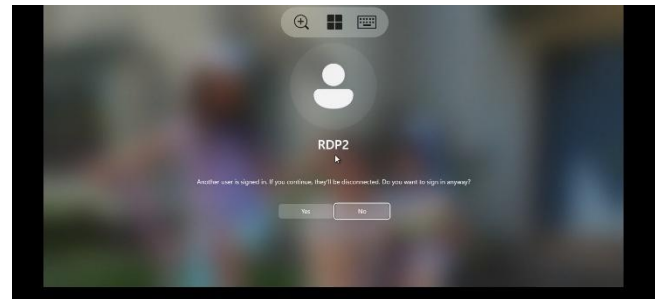

*Please remember to terminate the OpenVPN connection after you finish your Remote Desktop session to resume normal operation of your device.

Section 2. Android Device Client accessing Windows 11 Pro Host

2.1 Enable Windows 11 Pro Host for Remote Desktop Access

Please refer to Section 1, 1.1 for details

2.2 Setup Android Device Client:

1. Play Store → Search

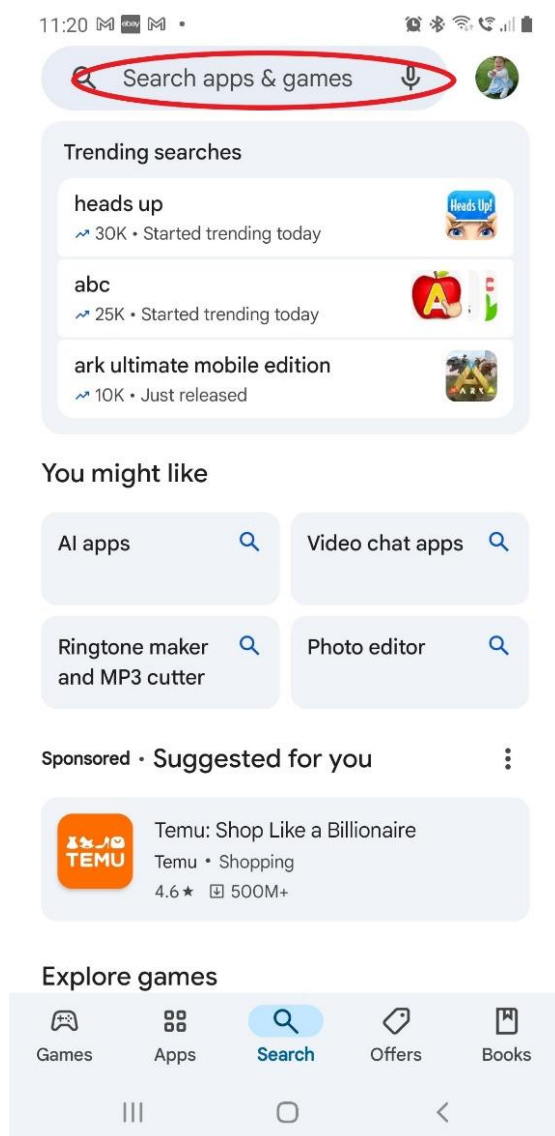

2. Search → Remote Desktop

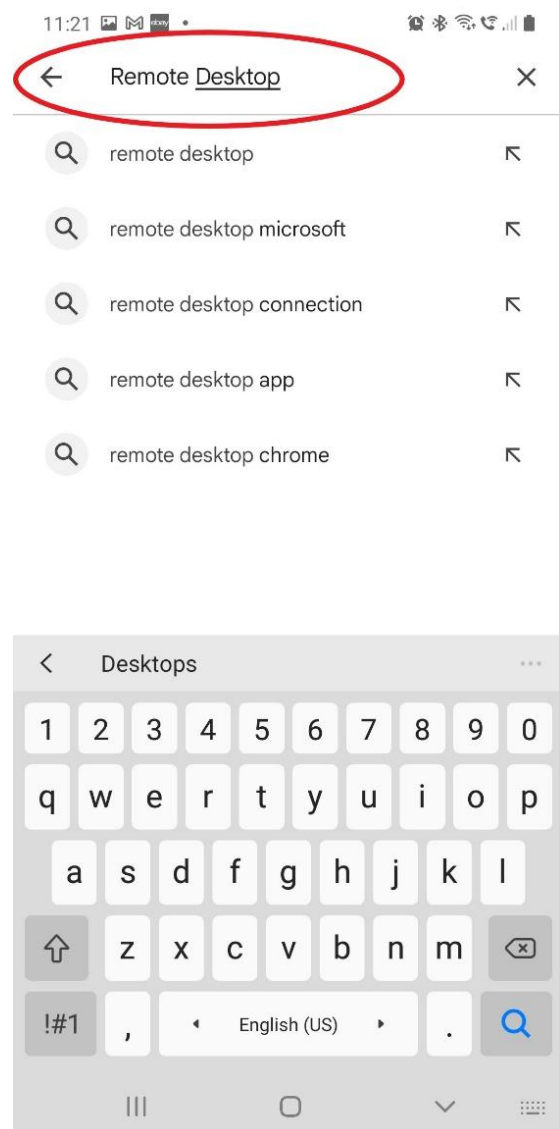

3. Select Remote Desktop app

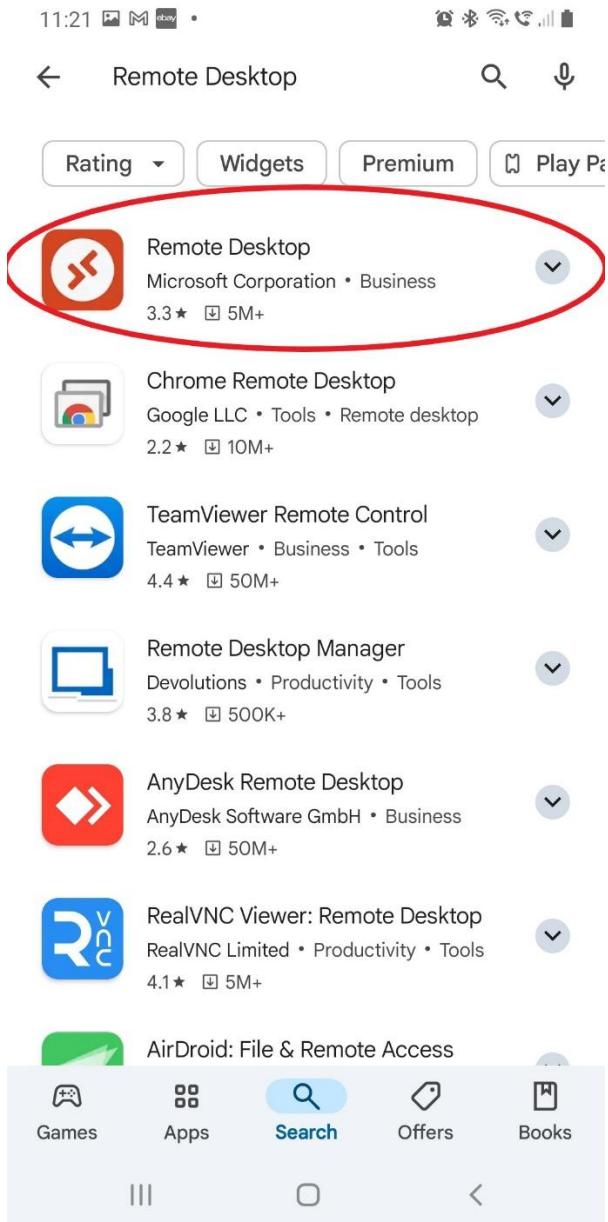

4. Install Remote Desktop app

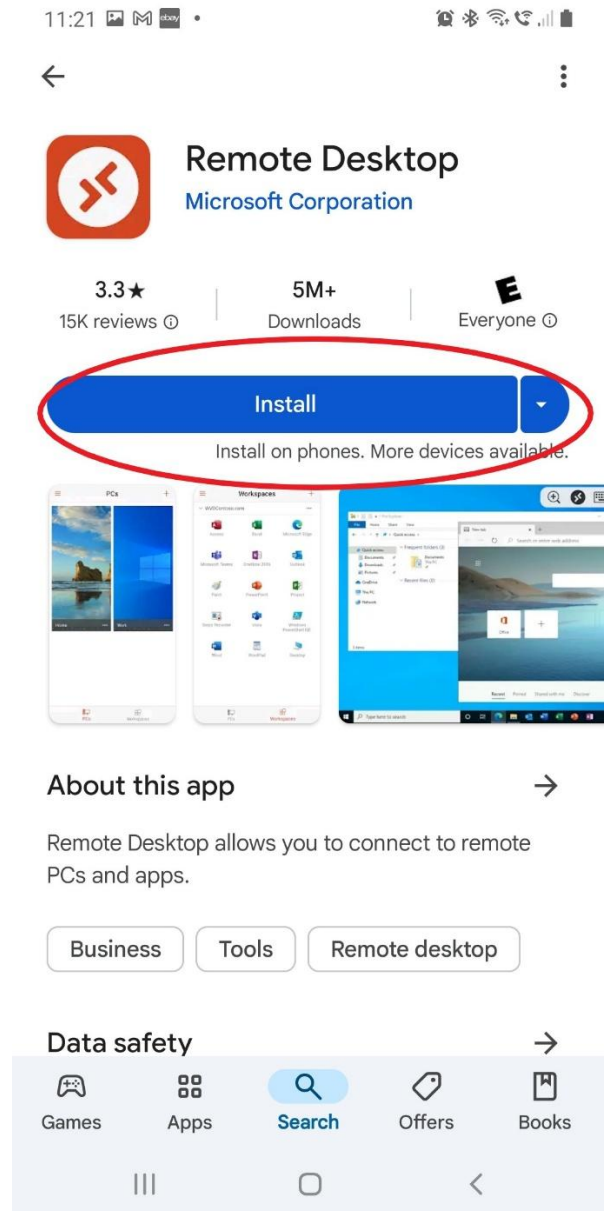

5. Make your PMG connection using OpenVPN Connect Client

6. Open Remote Desktop app

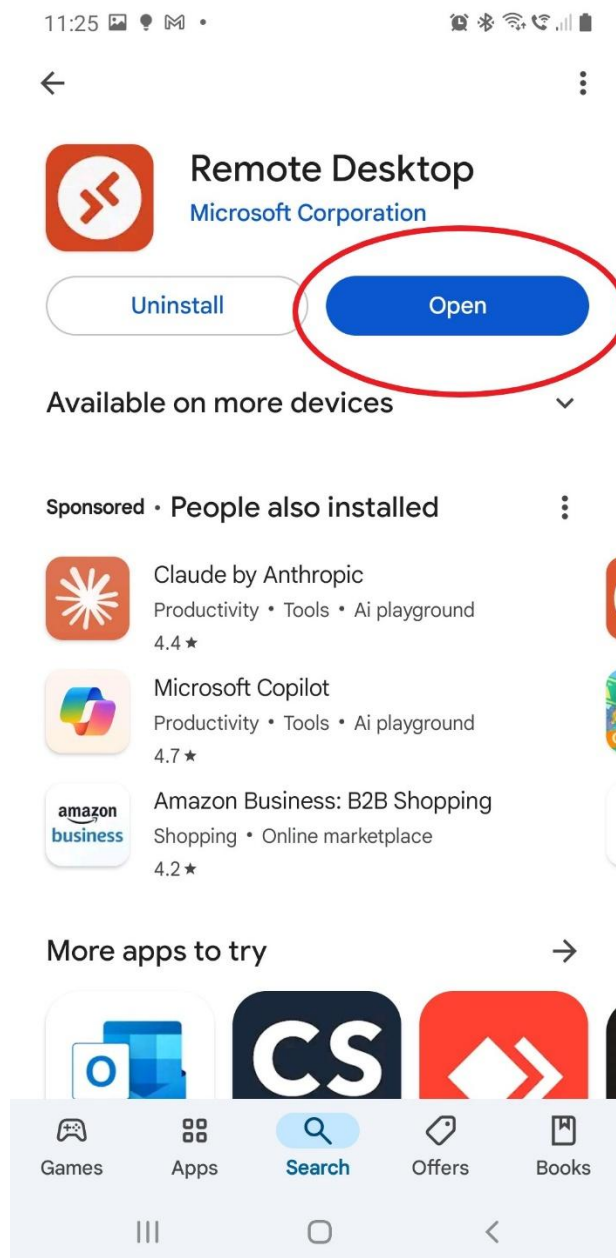

7. Accept License Terms

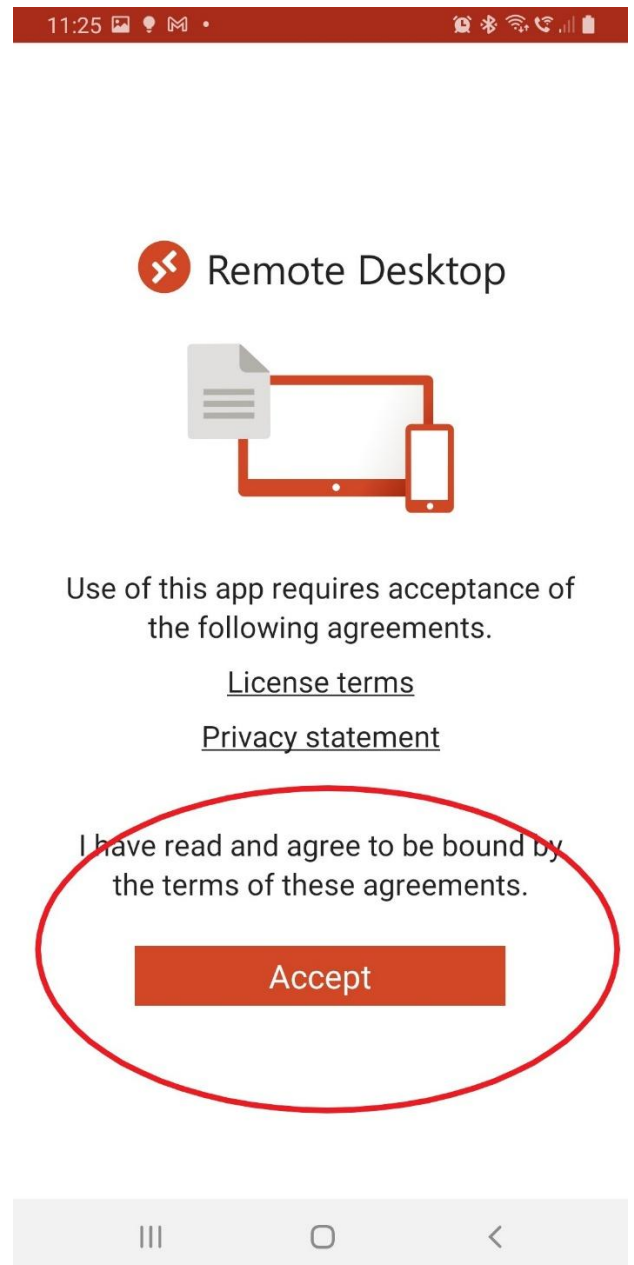

8. Add PC (HOST) (1)



9. Add PC (HOST) (2)

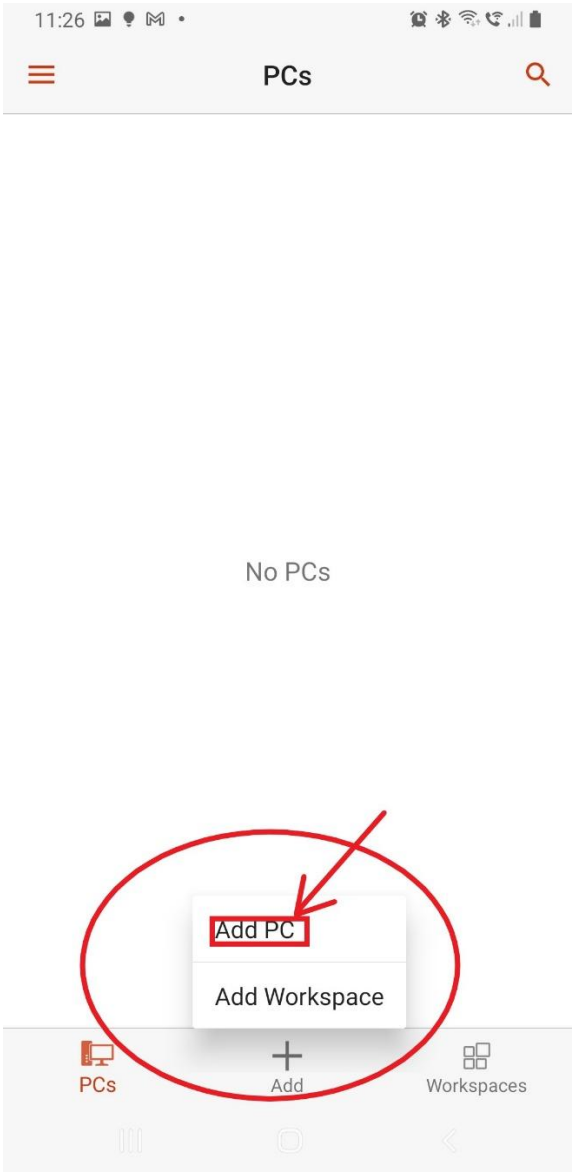

10. Add PC (HOST) (3)

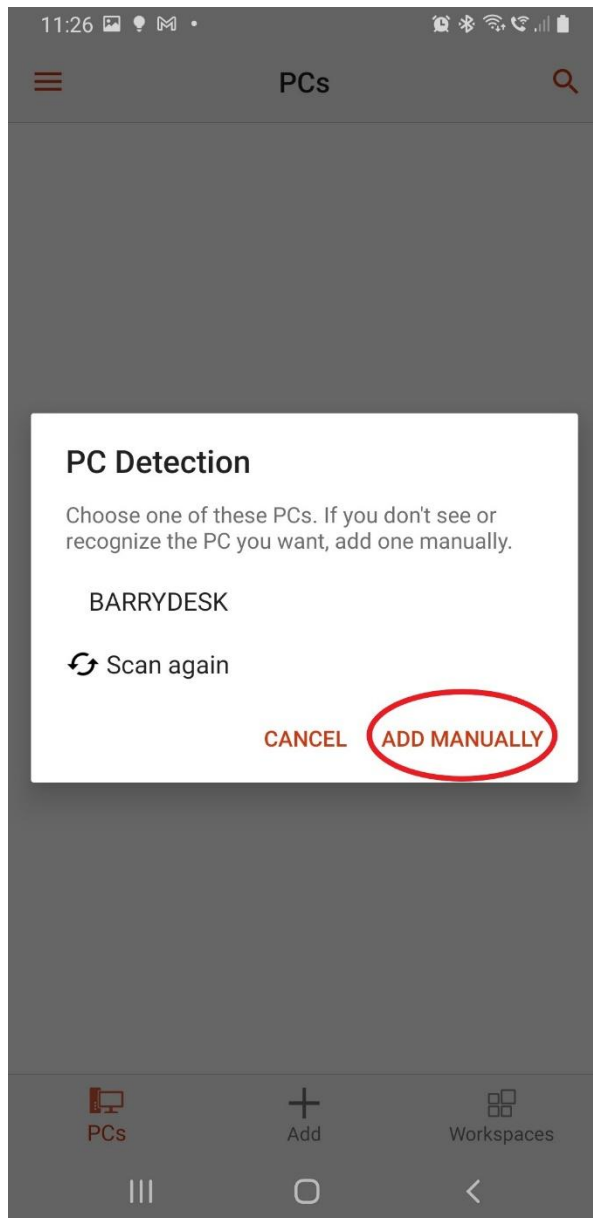

11. Add PC (HOST) (4)

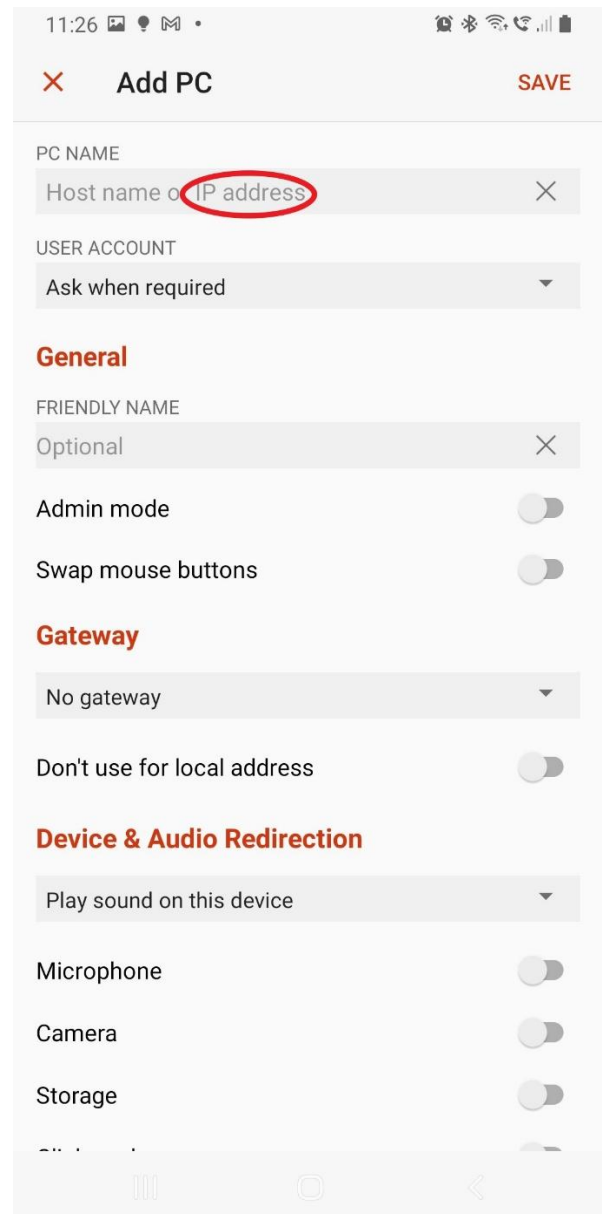

12. Add PC (HOST) (5)

11:27 11:27 11:27

Add PC SAVE

PC NAME
192.168.112.5

USER ACCOUNT
Ask when required ☒
Add user account ☐

FRIENDLY NAME
Optional

Admin mode ☐
Swap mouse buttons ☐

Gateway
No gateway

Don't use for local address ☐

Device & Audio Redirection
Play sound on this device

Microphone ☐
Camera ☐
Storage ☐

13. Add user Account (1)

11:27 11:27 11:27

Add PC SAVE

PC NAME
192.168.112.5

USER ACCOUNT
Ask when required ☒
Add user account ☐

FRIENDLY NAME
Optional

Admin mode ☐
Swap mouse buttons ☐

Gateway
No gateway

Don't use for local address ☐

Device & Audio Redirection
Play sound on this device

Microphone ☐
Camera ☐
Storage ☐

14. Add User Account (2)

11:28

Add PC **SAVE**

PC NAME
192.168.150.181

USER ACCOUNT
Ask when required

General

FRIENDLY NAME
Optional

Admin mode ☐

Swap mouse buttons ☐

Gateway

< 18th 1.0 11th ...

1 2 3 4 5 6 7 8 9 0

q w e r t y u i o p

a s d f g h j k l

↑ z x c v b n m ↵

!#1 , / ◀ EN(US) ▶ . .com Done

||| ○ ▼

15. Start Remote Desktop

11:31

PCs

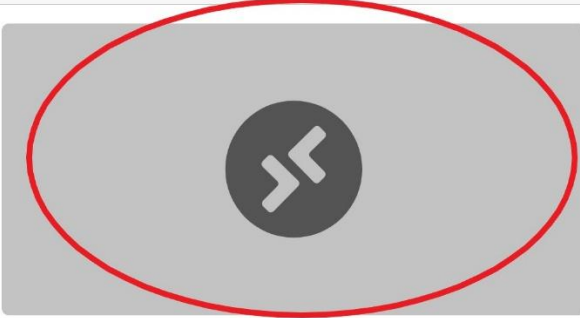

192.168.150.181
abcdef

PCs **Add** **Workspaces**

16. Enter User Credentials to Start

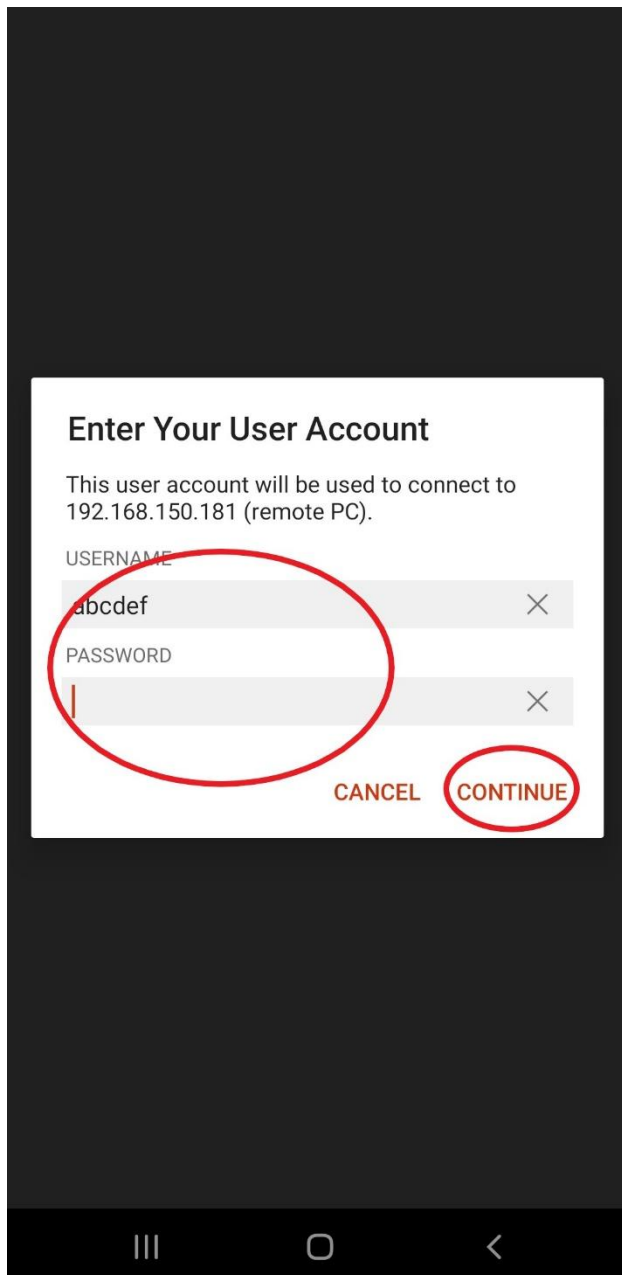

Enter Your User Account

This user account will be used to connect to 192.168.150.181 (remote PC).

USERNAME
abcdef

PASSWORD

CANCEL CONTINUE

17. Your Remote Desktop to the Target Host session will start after you successfully log in

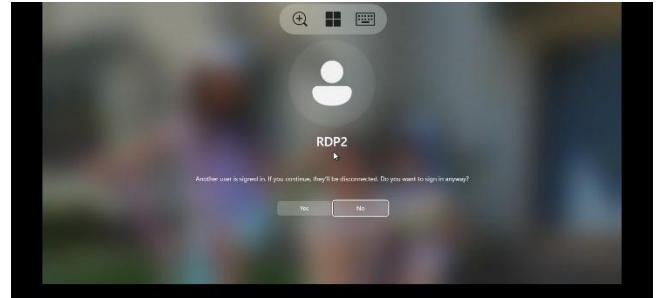

*Please remember to terminate the OpenVPN connection after you finish your Remote Desktop session to resume normal operation of your device.

Section 3. Windows Device Client accessing Windows 11 Pro Host

3.1 Enable Windows 11 Pro Host for Remote Desktop Access

Please refer to Section 1, 1.1 for details.

3.2 Setup Windows Remote Desktop Client

Step 1 Start → search Microsoft Store, then click on Microsoft Store

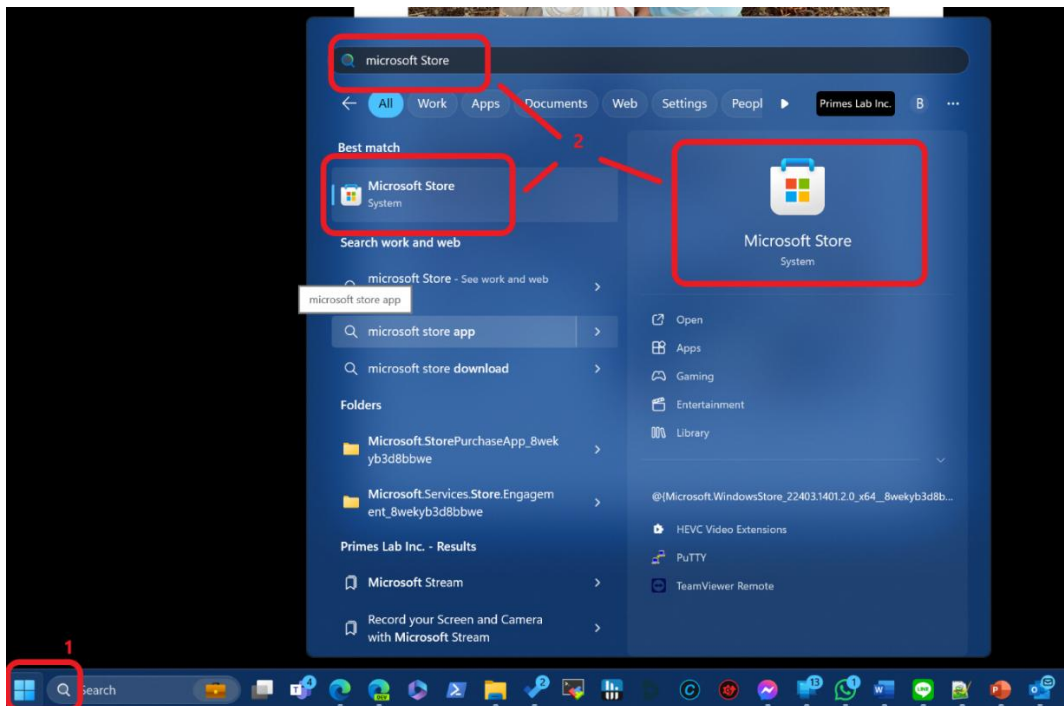

Step 2 Search remote desktop and Get to install

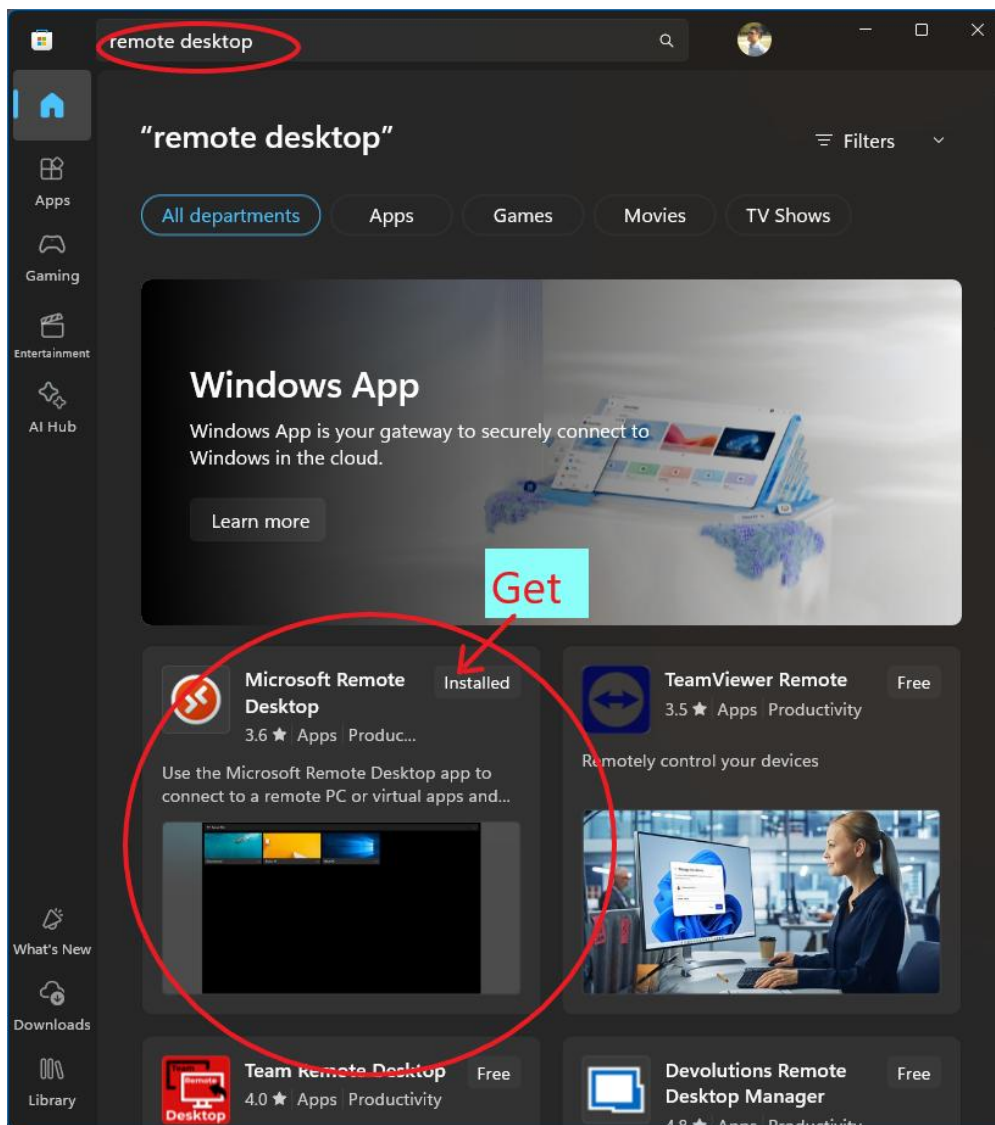
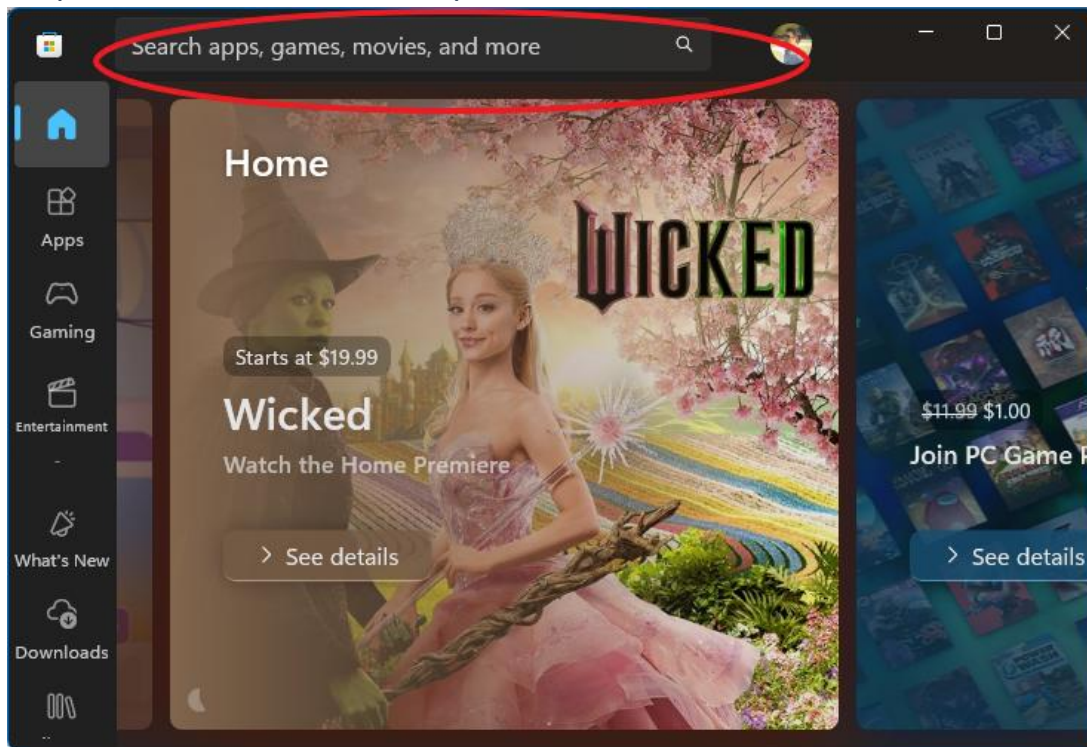

Step 3 Start Remote Desktop after making OpenVPN connection to PMG

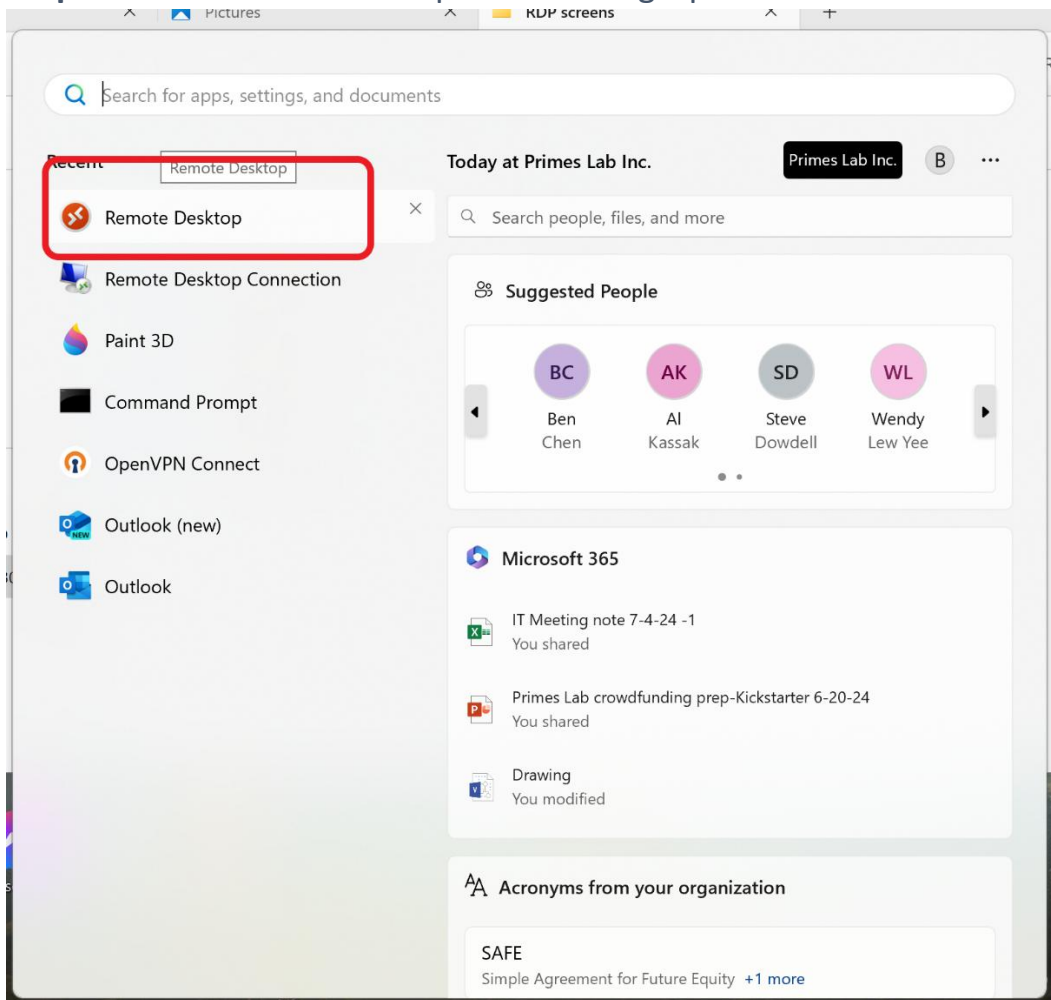

Step 4 Click on the "+", and select "PC"

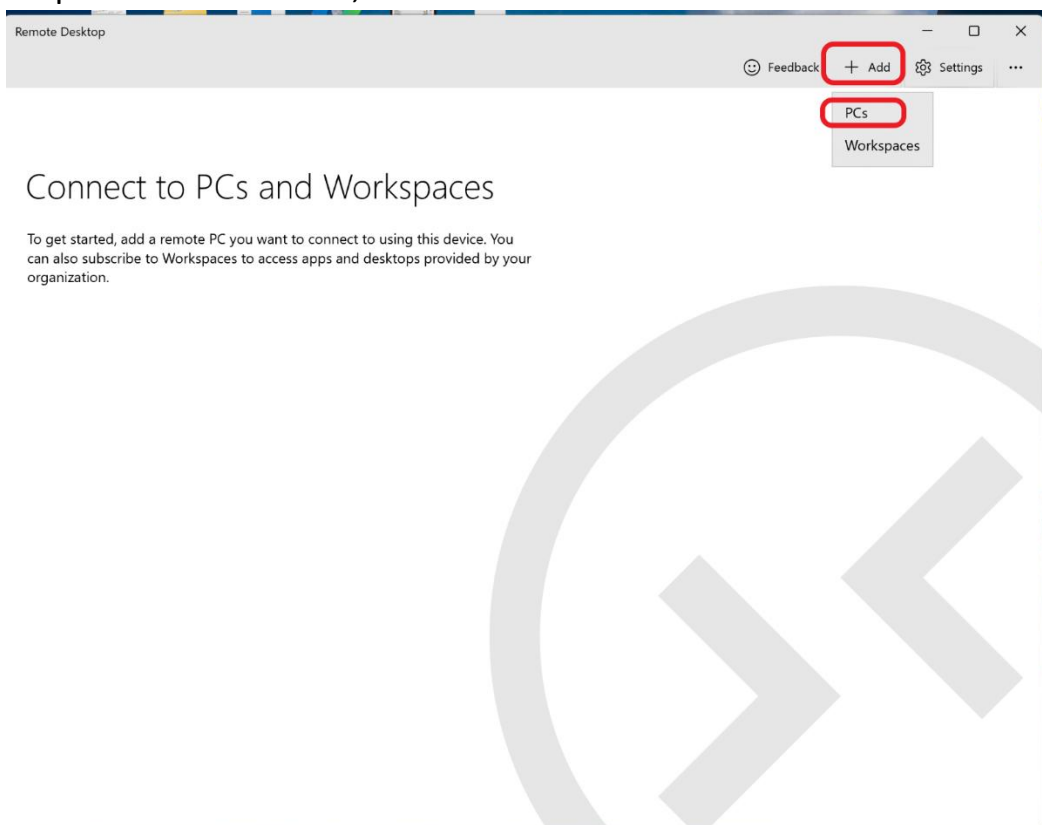

Step 5 Enter the IP and click on Save

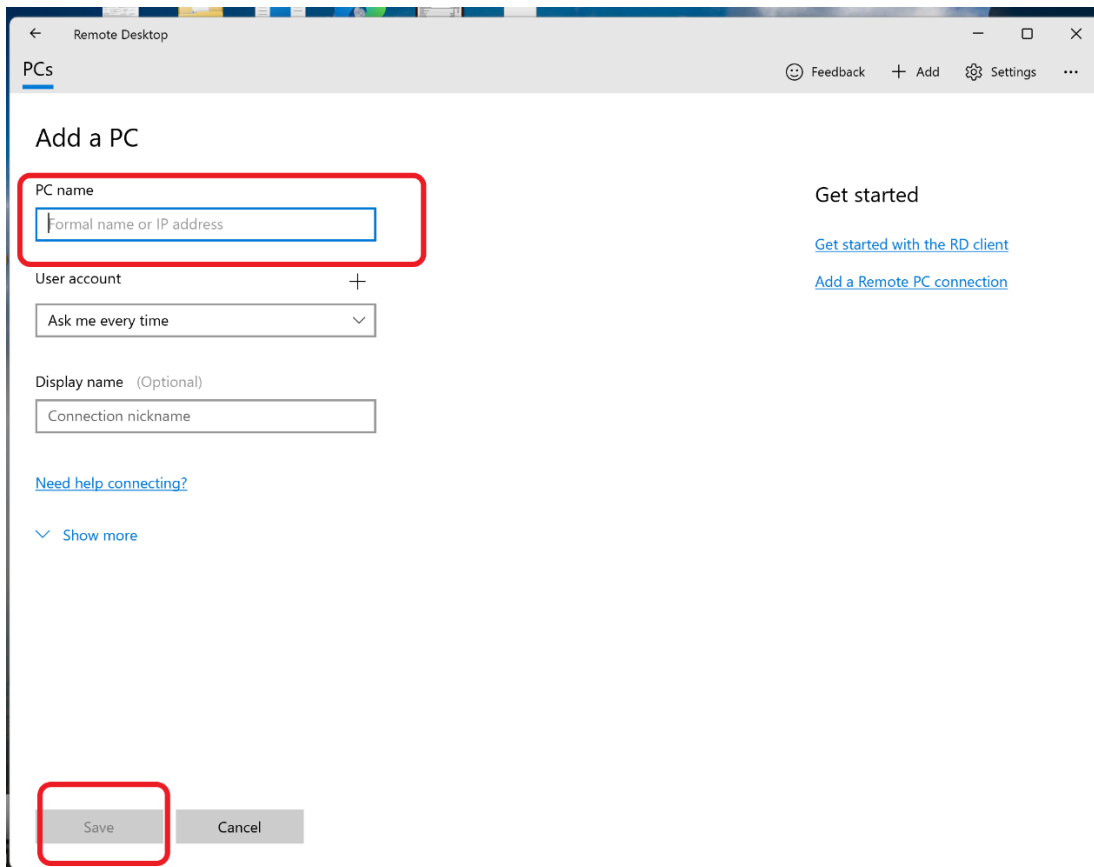

The screenshot shows the 'Add a PC' dialog in the Remote Desktop application. The 'PC name' field, which contains the placeholder text 'Formal name or IP address', is highlighted with a red rectangle. Below it, the 'User account' section has a plus sign and a dropdown menu currently set to 'Ask me every time'. The 'Display name (Optional)' section has a text field with the placeholder 'Connection nickname'. To the right, under 'Get started', there are two links: 'Get started with the RD client' and 'Add a Remote PC connection'. At the bottom left, the 'Save' button is highlighted with a red rectangle, next to a 'Cancel' button. A 'Show more' link is also visible.

Step 6 Your PC will show up (if you entered your optional Display Name, it will show up here.) Click on the PC

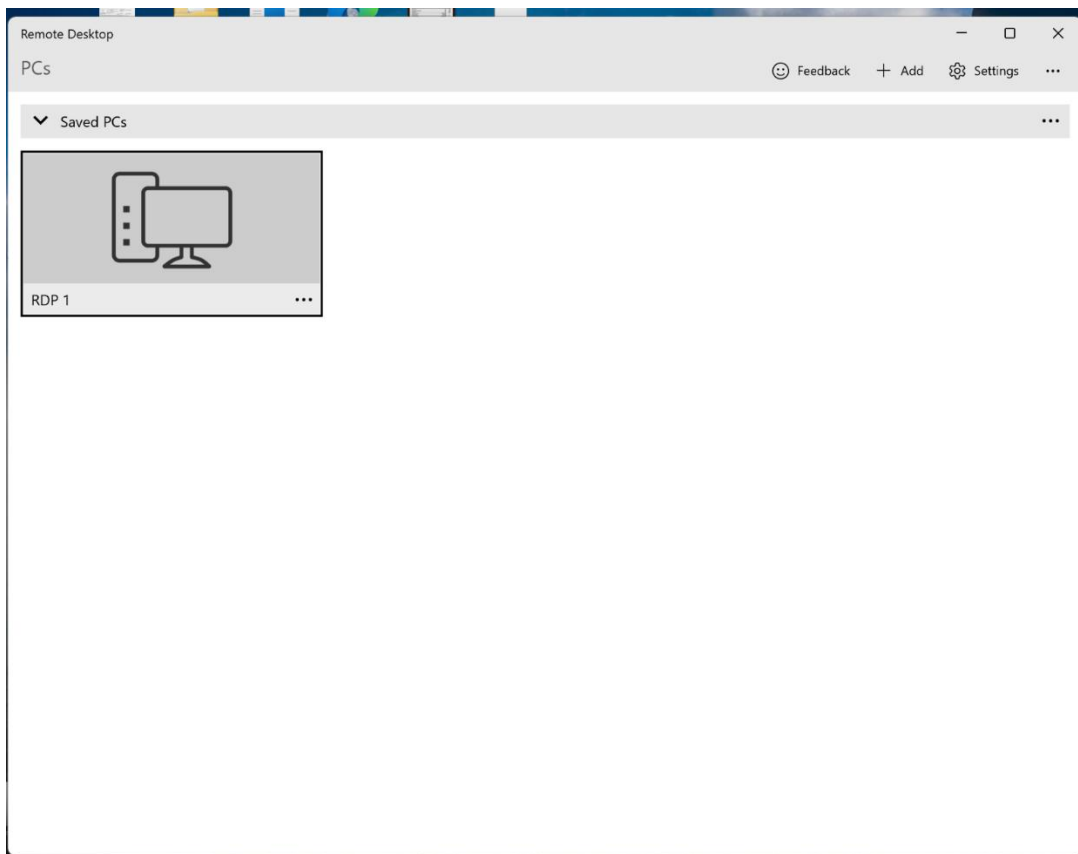

Step 7 Enter your username and password, then click on Connect

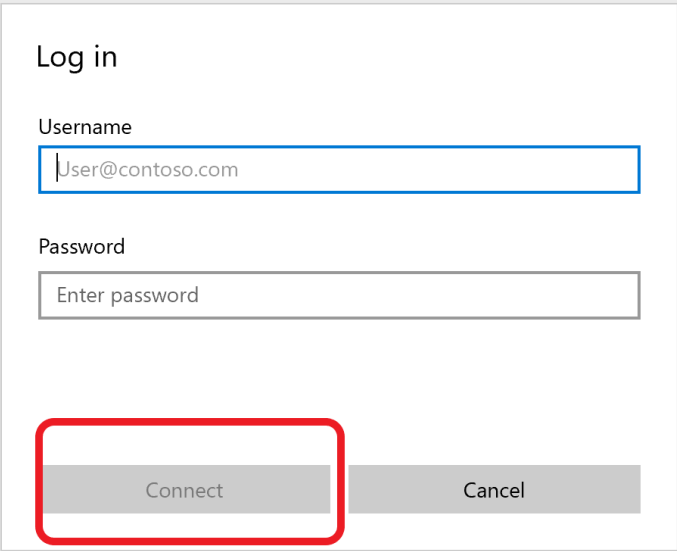

The screenshot shows a 'Log in' dialog box with a white background and a light gray border. At the top, the text 'Log in' is displayed. Below it, there are two input fields. The first is labeled 'Username' and contains the text 'User@contoso.com'. The second is labeled 'Password' and contains the placeholder text 'Enter password'. At the bottom of the dialog, there are two buttons: 'Connect' and 'Cancel'. The 'Connect' button is highlighted with a red rectangular border.

Step 8 You have made the connection and click on Yes to continue

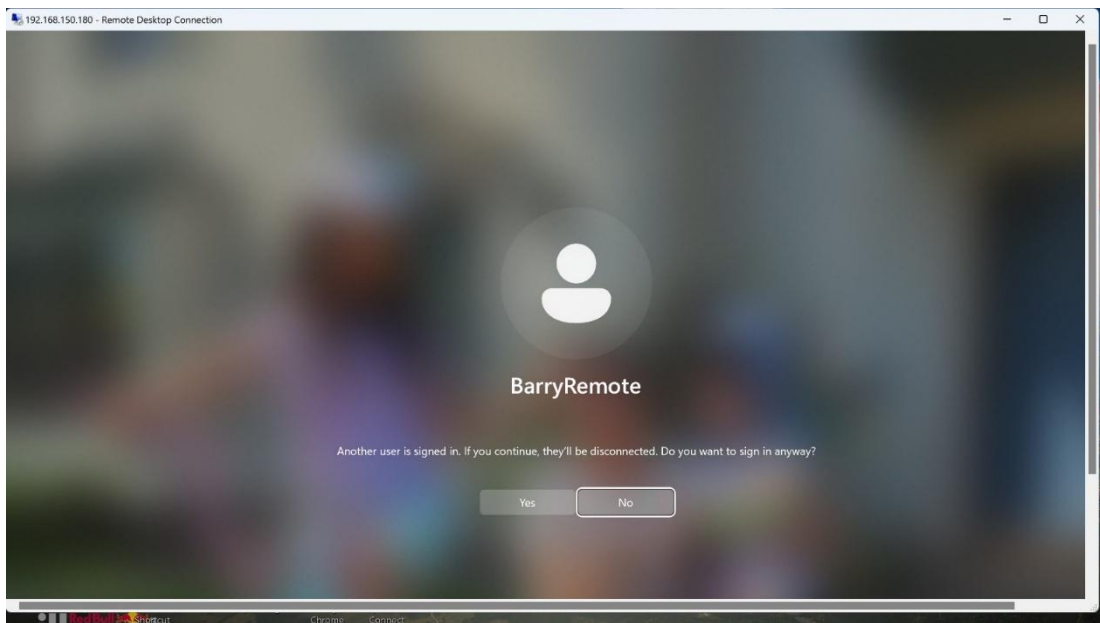

*Please remember to terminate the OpenVPN connection after you finish your Remote Desktop session to resume normal operation of your device.

Section 4. iOS Device Client accessing Windows 11 Pro Host

4.1 Enable Windows 11 Pro Host for Remote Desktop Access

Please refer to Section 1, 1.1 for details.

4.2 Setup macOS Remote Desktop Client

- 1 **Download the Microsoft Remote Desktop for Mac client:** Open the Mac App Store and search for "Microsoft Remote Desktop for Mac." Download and install the app.
- 2 **Make OpenVPN connection:** Use OpenVPN Connect app to connect to PMG.
- 3 **Launch RDP client app:** Launch the Microsoft Remote Desktop for Mac client from your Applications folder or Launchpad.
 - 3.1 **Add a PC:** Click on the "+" button and select "Add PC" to add the Windows host you want to connect to.
 - 3.2 **Enter details:** Enter the IP address of the Windows PC, and the credentials (username and password) for the Windows account. (Note: Windows Host IP address is required. Consult the Remote Desktop Host section of this document for locating the Host IP address if you don't have it already.)
 - 3.3 **Connect:** Click "Save" and then "Connect" to start the remote session.
- 4 After you finish your RDP session, please remember to disconnect the OpenVPN connection to your PMG to resume normal operation.

Section 5. Setup iOS Device Client accessing Windows 10 Pro Host

5.1 Enable Windows 10 Pro Host for Remote Desktop Access

Requirement: Windows 10 Pro is required for Remote Desktop service, please upgrade your windows 10 to "Pro" version if it is not.

Steps:

1. Open Settings.
2. Click on System.
3. Select Remote Desktop.
4. Toggle the Enable Remote Desktop switch to On.
5. Confirm when prompted.

Your Windows 10 Pro Host is now setup to accept Remote Desktop request now.

To Locate the IP address of your Target Host

Steps: (To be performed at your target host)

1. **Open Settings:** Click on the Start menu and select the gear icon to open Settings.
2. **Go to Network & Internet:** In the Settings window, click on "Network & Internet".
3. **Select Wi-Fi or Ethernet:** Choose either "Wi-Fi" or "Ethernet" depending on your connection type.
4. **View Properties:** Click on the network you're connected to, then click "Properties".
5. **Find IP Address:** Under "Properties," look for your IP address listed next to "IPv4 address".
6. **Record the IP address.**

5.2 Setup iOS Device Client:

Please refer to Section 1, 1.2 for details.

Section 6. Setup Android Device Client accessing Windows 10 Pro Host

6.1 Enable Windows 10 Pro Host for Remote Desktop Access Requirement:

Please refer to Section 5, 5.1 for details.

6.2 Setup Android Device Client

Please refer to Section 2, 2.2 for details.

Section 7. Setup Windows Device Client accessing Windows 10 Pro Host

7.1 Enable Windows 10 Pro Host for Remote Desktop Access

Please refer to Section 5, 5.1 for details.

7.2 Setup Windows Remote Desktop Client

Please refer to Section 3, 3.2 for details.

Section 8. Setup macOS Device Client accessing Windows 10 Pro Host

8.1 Enable Windows 10 Pro Host for Remote Desktop Access

Please refer to Section 5, 5.1 for details.

8.2 Setup macOS Device Client Remote Desktop Client

Please refer to Section 4, 4.2 for details.